

WALL MOUNTING PLATE AND FLANGE DETAIL

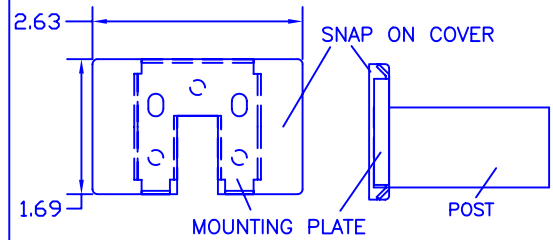

REV.#	DATE	DESCRIPTION	INITIALS	DOUBLE TPH (S-4569-01=S-4550)	Brey-Krause Mfg. Co.
				MATERIALS: S-4550-01 TOILET PAPER HOLDER ASM(CHROME PLASTIC)(SINGLE) S-4569-01 DOUBLE TOILET PAPER HOLDER ASM(CONVERSION KIT) POSTS-TYPE 304 SS .029 THICK ASSEMBLY IS FABRICATED FROM TYPE 304 STAINLESS STEEL. MOUNTING BRACKET IS WELDED TO POST. FLANGE COVER SNAPS OVER MOUNTING BRACKET TO CONCEAL MOUNTING SCREWS SPECIFY FINISH: SS=SATIN BS=BRIGHT	1209 West Lehigh St. Bethlehem, PA 18018 Ph. (610)867-1401 Fax (610)866-1433 e-mail: info@brey-krause.com
				DATE 11-15-01	SCALE
				DRAWN BY R.D.F.	